

## Specifications and Dimensions

### Flat Top Type

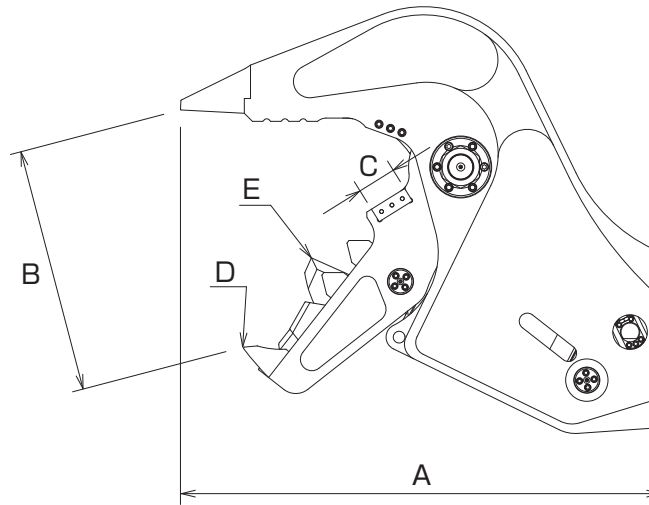

Model name		MC-75-TFT	MC-135-TFT	MC-452-TFT
Class of excavator	ton	6 - 8	12 - 14	40 - 45
Operating pressure	MPa (kgf/cm <sup>2</sup> )	24.5 (250)	31.4 (320)	
Max. operating pressure	MPa (kgf/cm <sup>2</sup> )	27.4 (280)	34.3 (350)	
Required flow rate	L/min	140	240	500
A Length	mm	1270	1480	2290
B Maximum jaw opening	mm	620	750	1200
C Cutting blade length	mm	100	120	210
D Crushing force at tip	kN (tf)	369 (38)	547 (56)	1380 (223)
E Crushing force at center	kN (tf)	534 (55)	882 (90)	2190 (141)
Mass	kg	580	1020	3940

- Single two-way hydraulic piping is required.
- We recommend reinforcing the stick of a hydraulic excavator that has this product installed.
- The weights in the table are reference values. For the weight of products, refer to “Product name-plates”.
- The attachment cannot be installed on a hydraulic excavator of a different class.

#### Diameter of rebar that can be cut by the MC Pulverizer

(Units: mm)

Model name	MC-75-TFT	MC-135-TFT	MC-452-TFT
Rebar diameter	φ25	φ32	φ51